



21 Philadelphia House, 6 Cross Bedford Street, Sheffield, S6 3BS

Saxton Mee

21 Philadelphia House

6 Cross Bedford Street

Offers Around

£110,000

Perfect for a first time buyer or professional couple is this modern and stylish first floor apartment, located in the popular Philadelphia House development just a stones throw away from the fashionable area of Kelham Island.

The living accommodation comprises: Entrance hallway with secure intercom entry system. Large double bedroom with side facing window. A trendy bathroom enjoys a full suite of bath and shower over, wash hand basin and W.C with large mirror above. The main living space is open plan, creating a great space to entertain with the lounge and dining area having a Juliet balcony. Fitted kitchen with integrated fridge, freezer, washing machine oven and dishwasher with breakfast bar seating area. Beyond the kitchen is the boiler storage room.

Externally there are well maintained, secure and gated communal grounds. On street parking.

Nearby Kelham Island has been recently awarded the 'Best Neighbourhood' by The Academy of Urbanism and is one of Sheffield's most sought-after locations. Surrounded by popular restaurants, bars and cafés it has almost every amenity you could think of while having regular transport links and easy access to both the City Centre and M1 motorway links. The various university campuses and main city hospitals can also be easily reached from here.

Leasehold - 233 years remaining



- Stylish City Centre Apartment
- Ideal For A First Time Buyer
- Close To Kelham Island And Central Sheffield
- Modern And Tasteful Decor Throughout
- EPC Rating - C
- Council Tax - Band B
- Tenure - Leasehold
- Viewing Via Banner Cross Office



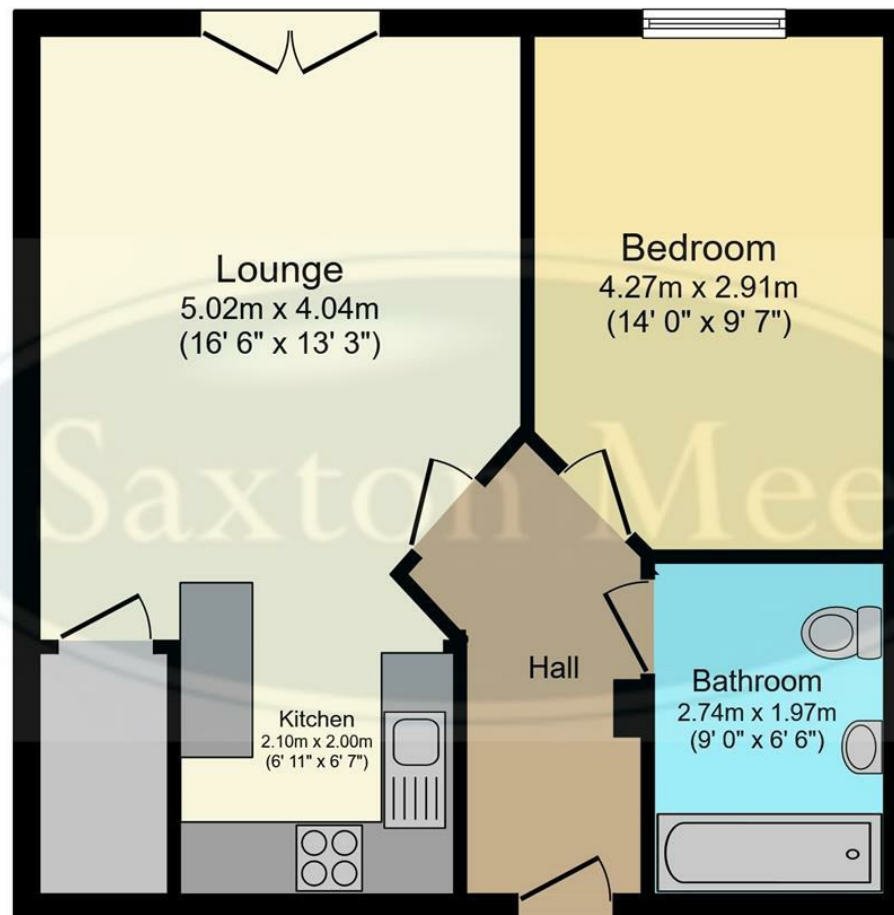

Floor Plan

Total floor area 49.9 sq.m. (537 sq.ft.) approx

This plan is for illustration purposes only and may not be representative of the property. Plan not to scale. Powered by PropertyBox

While we endeavour to make our sales particulars fair, accurate and reliable, they are only a general guide to the property and, accordingly, if there is any point, which is of particular importance to you, please contact the relevant office. The Agents have not tested any apparatus, equipment, fittings or services and so cannot verify they are in working order. The buyer is advised to obtain verification. Please note all the measurement details are approximate and should not be relied upon as exact. All plans, floor plans and maps are for guidance purposes only and are not to scale. Under no circumstances should they be relied upon as exact or for use in planning carpets and other such fixtures, fittings or furnishings. YOUR HOME IS AT RISK IF YOU DO NOT KEEP UP REPAYMENTS ON A MORTGAGE OR OTHER LOAN SECURED ON IT. 'A Life Assurance policy may be requested.' 'Written Quotations of credit terms available on request.'

Banner Cross
T: 0114 268 3241
E: bannercross@saxtonmee.co.uk
www.saxtonmee.co.uk

Dronfield
T: 01246 290992
E: dronfield@saxtonmee.co.uk

Hathersage
T: 01433 650009
E: hathersage@saxtonmee.co.uk

Bakewell
T: 01629 815307
E: bakewell@saxtonmee.co.uk

